

Men Over 60s,65s,70s,75s

# MASTERS WORLD CUP TOKYO 2022

OI HOCKEY STADIUM  
19 -29 OCTOBER



## INFORMATION PACK Version 3



スポーツ振興基金  
独立行政法人日本スポーツ振興センター

# SPONSORS - 1

## Official Partners



Be sure to support our Tournament  
Sponsors & Partners

## SPONSORS - 2

### Official Supporters



### Official Sponsors



スポーツ振興基金助成事業

この大会はスポーツ振興基金の助成を受けて開催されています。

独立行政法人日本スポーツ振興センター





# Welcome from Japan Hockey Association - 1

Dear Masters Hockey Friends,

First of all, I would like to thank WMH and masters hockey officials of national associations from across the world for your support for the WMH World Cup in Tokyo in 2022. As you are well aware, all WMH events scheduled to be held in 2020 and 2021 were postponed, so I would like to take this opportunity at last to welcome you all to Tokyo!

We have secured the two pitches at Oi Hockey Stadium, where the postponed Tokyo Olympic hockey was held in 2021. This will be the first time ever for a Masters World Cup to be held on official Olympic pitches, and we are sure the visiting teams and officials will enjoy the world-class facilities, and playing hockey on the near-perfect surfaces.

This event in the metropolitan area of Tokyo will also show the city inhabitants how senior people from all around the world are enjoying this sport as a life-long pastime. With life expectancy now reaching over 100 years, particularly here in Japan, I am sure that this tournament, showcasing some of the world's fittest 60-80 year-olds, will impress many first-time viewers! (continued next slide...)

Junichi 'Jimmy' SEKIYA  
President - Japan Masters



# Welcome from JHA - 2

We would also like to acknowledge the enormous contribution of Mr Wim van Noortwijk to international Masters Hockey for the over 60s categories. Sadly, he passed away two years ago and this is the first World Cup to be held without his indomitable energy and drive. We miss him greatly and know he would be very proud to see us all gathering together again like this in Tokyo.

Masters Hockey brings us meaningful chances for enriching our life, making new friendships, and connecting world societies. I am convinced that this WMH World Cup in Tokyo in 2022 will bring us all a great opportunity to revive old connections and create new friendships among international masters hockey players.

After such a long wait, we are really looking forward to welcoming all of the teams, officials, family members, and friends to the WMH World Cup in Tokyo. Yokoso and See you soon!

Very best wishes from,  
Junichi 'Jimmy' SEKIYA  
President - Japan Masters



# TOURNAMENT KEY DATES

Event	Date	Location	Time
<b>Tournament Director Pre-Event Information</b>	Sep/Oct	On-Line Meetings	0:00
<b>Kit &amp; Passport Check</b>	Mon 17th and Tue 18th October	Oi Hockey Stadium (OHS) Main Pitch	
<b>Opening Ceremony</b>	Tue 18th October	Oi Hockey Stadium (OHS) Main Pitch	3:00pm
<b>Team Managers Meeting</b>	Tue 18th October	Oi Hockey Stadium (OHS) Main Pitch	5:00pm
<b>Exhibition Match</b>	Sat 22nd October	Oi Hockey Stadium (OHS) Main Pitch	5:30pm
<b>Tournament Dinner</b>	Fri 28th October	Meiji Kinenkan Garden	5:30pm
<b>Closing Ceremony</b>	Sat 29th October	Oi Hockey Stadium (OHS) Main Pitch	Post Match

# KEY PERSONNEL

Position	Name
<b>WMH President</b>	Mr Glenn PATON
<b>WMH Event Manager</b>	Ms Ishbel DICKENS
<b>Japan Masters President</b>	Mr Junichi (Jimmy) SEKIYA
<b>Japan Masters Secretary</b>	Mr Kenji HAMANAKA
<b>JHA Secretary General</b>	Mr Nobuo ISHIKAWA
<b>Tournament Director (TD)</b>	Mr Kiyoshi SANA
<b>Umpires Manager (UM)</b>	Mr John HERON
<b>WMH/JHA Liaison</b>	Mr Kevin DEMPSTER
<b>Visa Operations JHA</b>	Mr Koichi UCHIYAMA
<b>Venue &amp; Equip Manager</b>	Mr Yoshiya KANNO
<b>Field of Play Coordinator</b>	Mr Yutaka HIRAO
<b>Information/Media Manager</b>	Mr Yoshimitsu UMEZAWA
<b>Accommodation Manager</b>	Mr Fusao SATO
<b>Medical Services</b>	Mr Takeo ARAI



**Photo: First meeting of Tokyo HNOC in Feb 2019**





# COMPETITION & TRAINING - 1

## Teams Competing

We have 27 teams, representing 12 countries, competing at this World Cup event.

There will be games taking place all day long over the eleven days of the tournament on the two Olympic pitches at Oi Hockey Stadium.



Country/Team	O60	O65	O70	O75
Australia				
Canada				
England				
Ireland				
Italy				
Japan				
Malaysia				
Scotland				
Singapore				
South Africa				
USA				
Wales				
Japan SoM				
Alliance SoM				
Southern Cross				



# COMPETITION & TRAINING - 2

## Competition Format

The teams will compete in the following pools:



Over 60 Men		Over 65 Men	Over 70/75 Men	
Pool A	Pool B	Group	Pool A	Pool B
ENG JPN RSA ITA CAN JPN SoM	AUS SCO USA SGP MAS SouthX SoM	AUS JPN IRE RSA USA MAS SouthX SoM	AUS 70 JPN 70 SouthX SoM JPN 75	WAL 70 RSA 70 ALL 70 SoM JPN 70 SoM

The winners of a match will be awarded three points, with one point awarded to each team in the event of a draw and zero for a loss. After all matches have been played, the ranking in each pool will be determined by total points, with ties broken by the total number of wins, then goal difference, then goals scored, then the result(s) of the match(es) between the two or more tied teams, then the number of field goals. If the teams remain tied after all these tiebreakers, a shoot-out competition (or penalty stroke competition for O/70s) will be held to determine the rankings.





# COMPETITION & TRAINING - 3

## Competition Format

The match schedule created by WMH and can be found at:  
[https://drive.google.com/file/d/12HB9auG9JoOqCaOiK1JTG2ci\\_mglOGRJ/view](https://drive.google.com/file/d/12HB9auG9JoOqCaOiK1JTG2ci_mglOGRJ/view)

The teams have been allocated to several pools based on their seedings. The format of the competition will be as per WMH Competition Handbook Part B

## Over 60s Men

10 teams, 2 SoM teams

Pool A: 6 teams & Pool B: 6 teams

SoM teams ranked 6th in each Pool

Round Robins followed by:

Class 1-4: 4 team Semi-finals (1st & 2nd in each Pool)

Class 5-8: 4 team Classification (3rd & 4th in each Pool)

Class 9 & 10 Classification Match (5th A v 5th B)

Spirit of Masters (SoM) Final (6th A v 6th B)

## Over 65s Men

6 teams, 1 SoM team

One Pool 7 teams

SoM team ranked 7th in Pool (SoM Final not applicable)

Round Robin followed by:

Class 1 & 2 Final (1st v 2nd in Pool)

Class 3 & 4 Classification Match (3rd v 4th in Pool)

Class 5 & 6 Classification Match (5th v 6th in Pool)

## Over 70-75s Men

4x70 teams, 3x70 SoM teams, 1x75 team

Pool A: 4 teams & Pool B: 4 teams

75 team ranked 4th in Pool A (Final not applicable)

70 SoM team ranked 3rd in Pool A;

70 SoM teams ranked 3rd & 4th in Pool B

Round Robins followed by:

70 Class 1-4: 4 team Semis (1st & 2nd in each Pool)

70 Spirit of Masters (SoM) Elimination & Final

(3rd A v 4th B; Winner v 3rd B; Loser ranked 3rd)

75 team & 70 SoM teams non-competitive matches



# Teams – Japan (Host Nation)

## Japan O/60s



- |                      |                             |
|----------------------|-----------------------------|
| 1 WADA Shinji (GK)   | 14 DEGUCHI Atsuhiko         |
| 4 NISHIDA Kei (GK)   | 15 KANAYAMA Ryuichi         |
| 5 MATSUI Terumasa    | 16 ARAI Yoshio              |
| 6 MAKIMOTO Satoshi   | 17 UESUGI Kazunori          |
| 7 YAMADE Yuji        | 18 MOCHIZUKI Hiroaki        |
| 8 TAKII Miyoharu     | 25 UEDA Tomoyuki            |
| 9 TAKESHITA Tetsushi | 26 TACHIKAWA Zenichiro      |
| 10 TAKAMORI Koji (C) | KATO Hiroshi - Manager      |
| 11 DEMPSTER Kevin    | AMEMIYA Hideo -Physio       |
| 12 TOKUI Hirokazu    | MASUOKA Tomoyuki -Physio    |
| 13 SAWADA Masahiro   | KAWANISHI Norihide – Physio |

## Japan O/65s



- |                     |                             |
|---------------------|-----------------------------|
| 1 HAMAOKA Koji (GK) | 13 KUNIHIRO Toshiharu       |
| 2 TOKUMASU Masayuki | 15 MIZUTANI Yoshio (C)      |
| 3 MATSUO Hideo      | 16 TAKAKURA Teruhisa        |
| 4 SAGO Shigeharu    | 18 ASANO Kazuo              |
| 5 HOSHI Masami      | 19 KOYAMA Takashi           |
| 6 YUZAWA Mutsuto    | 20 AOTA Hiroshi (GK)        |
| 7 ISHIKAWA Nobuo    | 21 HASEGAWA Masanao         |
| 8 MOTOMURA Hirofumi | 50 GOTO Yukio               |
| 11 YOSHIDA Takaaki  | KATO Hiroshi - Manager      |
| 12 KAWASHIMA Shim   | AMEMIYA Hideo -Physio       |
|                     | MASUOKA Tomoyuki -Physio    |
|                     | KAWANISHI Norihide – Physio |

## Japan O/70s



- |                      |                         |
|----------------------|-------------------------|
| 1 HASHIMOTO Keiichi  | 14 TOJIGAMORI Osamu     |
| 2 USHIBANA Koji      | 17 MIZOKAMI Masaharu    |
| 3 IMOSE Shuji        | 30 TOGASHI Kazushi (GK) |
| 4 YOSHINARI Hiroyuki | 32 HIRAO Takafumi       |
| 5 KAWAKAMI Hoji (C)  | 33 TAJIMA Mitsuyuki     |
| 6 SATAKE Haruo       | 34 KUCHIDA Junji        |
| 7 SHIKANO Ikuro      | 36 NAKANISHI Takeyoshi  |
| 8 TAKASE Muneyasu    | SAHARA Hikaru - Manager |
| 9 YAMAMOTO Takeo     | AMEMIYA H -Physio       |
| 10 TSUTSUMI Masaaki  | MASUOKA T -Physio       |
| 11 YOKOTA Nobuaki    | KAWANISHI N – Physio    |





# Teams – Japan (Host Nation)

## Japan O/75s



- |                         |                        |
|-------------------------|------------------------|
| 1 OHTA Hideki (GK)      | 15 KAMIMURA Yukio      |
| 2 ISHIZAKI Eiji         | 16 TSUTSUI Yasutoshi   |
| 3 TANIGUCHI Suguru      | 18 MATSUMOTO M.        |
| 4 HIGASHIHARA Hiroaki   | 19 YOSHIDA Yoshihiro   |
| 5 MIYAMOTO Ryuso (C)    | 22 TSUJI Yasuo         |
| 6 YOSHIUCHI Masaaki     |                        |
| 7 MORISAKA Toshiaki     |                        |
| 9 AMEMIYA Saburo        | KATO Hiroshi - Manager |
| 10 OKUSHIMA Shunsuke    | AMEMIYA Hideo -Physio  |
| 12 SEKIYA Junichi       | MASUOKA T. -Physio     |
| 14 MIZUTANI Taichi (GK) | KAWANISHI N. – Physio  |

## Japan SoM O/60s



- |                      |                         |
|----------------------|-------------------------|
| 20 KAWAKAMI Masatomo | 36 SHIBATA Takuro       |
| 21 FUKUYAMA Takehiko | 37 KANNO Yoshiya        |
| 22 ABE Kenji (C)     | 38 MATSU Yoshikazu      |
| 23 SASAKI Sakae      | 39 KATO Masafumi        |
| 24 SAWAURA Setsuo    | 40 KISO Yasuharu        |
| 27 TAKAHASHI Sunao   | 41 ITO Yasukiyo         |
| 29 NAKAJIMA Yasuhito | 42 ITSUKI Yoshio        |
| 32 TAMURA Hajime     | SAHARA Hikaru - Manager |
| 33 SAKAI Jun         | AMEMIYA Hideo -Physio   |
| 34 YASUKURA Hiroshi  | MASUOKA T. -Physio      |
| 35 UCHIYAMA Koichi   | KAWANISHI N. – Physio   |

## Japan SoM O/70s



- |                       |                        |
|-----------------------|------------------------|
| 1 NAKAMURA Yoshio     | 40 OKAMOTO Arihiro     |
| 23 SOGABE Hiroshi     | 42 YAMAOKA Toshihiko   |
| 24 MINAMIZAKI Shigeru | 43 YAMADA Toshifumi    |
| 25 ARAI Takeo         | 44 SUGA Masanori       |
| 26 NISHIGAKI Takendo  | 45 YAMADA Akihiro      |
| 27 KISA Yasuhiko      | 46 ABURA Kazuhiko      |
| 31 ASAI Toru (C)      |                        |
| 36 HAMANAKA Kenji     | SHIMOMURA T. - Manager |
| 37 SUSUKI Tosaku      | AMEMIYA Hideo -Physio  |
| 38 FURUZAWA Tamotsu   | MASUOKA T. -Physio     |
| 39 KAMIO Toyohiko     | KAWANISHI N. – Physio  |





# Teams – Australia

## Australia O/60s



- |                     |                            |
|---------------------|----------------------------|
| 1. Tony Jones       | 12. David McPherson        |
| 2. Alan Kidd        | 13. Brian Robinson         |
| 3. Kevin McLaughlin | 14. Bede Rogers            |
| 4. Bruce Buchanan   | 15. Philip Price           |
| 5. Craig Burgess    | 16. Philip Shaw            |
| 6. Michael Collins  | 17. Stephen White          |
| 7. Alan Ferguson    | 18. Simon Winter           |
| 8. Martin Ferrari   |                            |
| 9. Ian Ferreira     | Coach: Cameron Fairbrother |
| 10. Warren Jenkins  | Manager: Sue Hollier       |
| 11. Lyle Kenny      | Physio: Sharon Dixon       |

## Australia O/65s



- |                     |                           |
|---------------------|---------------------------|
| 1. Paul Murray      | 12. Geoff Robinson        |
| 2. David Campbell   | 13. Norman Same           |
| 3. Don Bowser       | 14. Stephen Sawyers       |
| 4. Mark Finch       | 15. Peter Shepherd        |
| 5. Clive Harrison   | 16. Paul Spencer          |
| 6. Paul Leadbeatter | 17. Don Trewin            |
| 7. Peter Mann       | 18. Peter Urie            |
| 8. Dennis Martin    |                           |
| 9. Mark McElligott  | Coach: Rob Lawson         |
| 10. Robin Meagher   | Manager: Carolyn Campbell |
| 11. Robert Redding  | Physio: Sharon Dixon      |

## Australia O/70s



- |                   |                       |
|-------------------|-----------------------|
| 1. Denis Lovell   | 13. Robert McNeil     |
| 2. Rod Dyson      | 14. Raymond Northwood |
| 3. Winton Inkster | 15. Don Sanders       |
| 4. John Chapman   | 16. Col Shepperd      |
| 5. Barry Collins  | 17. Richard Staynor   |
| 6. Neil Coster    | 18. Ronald Tippet     |
| 7. Trevor Dancer  |                       |
| 8. Noel French    |                       |
| 9. John Hearne    | Coach: Craig Williams |
| 10. John Hore     | Manager: Susan Reid   |
| 12. Rudy Keswick  | Physio: Sharon Dixon  |



# Teams – Canada, England, Ireland

## Canada O/60s



- |                     |                    |         |
|---------------------|--------------------|---------|
| 1. Peter Jardine    | 13. Mark Northcote |         |
| 3. Dave Bissett     | 14. Peadar O'Riain |         |
| 4. Bubli Chohan     | 15. Patrick Oswald |         |
| 5. Stephen Dearing  | 16. Seamus Parker  |         |
| 6. Andrew Haigh     | 17. Gord Plottel   |         |
| 7. Mark Hamilton    | 18. Robert Stowe   |         |
| 8. Jim Jenkyns      | 19. Mike Millard   |         |
| 9. Gursharan Jheeta | PATERSON Don       | Manager |
| 10. Landon Kitagawa | HOBKIRK Alan       | Coach   |
| 11. John McCulloch  | MCCULLOCH Juli     | Doctor  |
| 12. Perry Mody      | MUTH Theo          | Physio  |

## England O/60s



- |                    |                        |
|--------------------|------------------------|
| 1. Mark Boothroyd  | 12. Mark French        |
| 2. Rob Leach       | 13. Richard Milbourn   |
| 3. Keith Hall      | 14. Mike Pell          |
| 4. Jon Peplow      | 15. Nigel Bower        |
| 5. Chris Picken    | 16. Jim Laslett        |
| 6. Andy Law        | 17. David Knapp        |
| 7. John Russell    | 18. Rob Brown          |
| 8. Avtar Khangure  |                        |
| 9. Peter Jakob     | Coach: Angus Batchelor |
| 10. Andy Batchelor | Manager: Sarah Pell    |
| 11. Rod Naughalty  |                        |

## Ireland O/65s



- |                      |                       |
|----------------------|-----------------------|
| 1. Tim Hogg          | 68. Brendan Rice      |
| 24. Stuart Switzer   | 79. Andy Matthews     |
| 26. Fergus Stapleton | 83. Charlie Taylor    |
| 27. Eddie O'Malley   | 84. Billy Dowie       |
| 28. Keith Jess       | 86. Roger West        |
| 34. Billy Pollock    | 101. Tim Myers        |
| 35. Stuart Egner     | 111. David Kiernan    |
| 39. Richard Clarke   |                       |
| 46. Henry Brown      | Coach: Sean Curran    |
| 49. Martyn Cremin    | Manager: Norma Clarke |
| 53. Carl Collings    |                       |





# Teams – Italy, Malaysia

## Italy O/60s



- |                         |                           |
|-------------------------|---------------------------|
| 2. Antonio Parisi       | 82. Massimo Massera       |
| 4. Gigi Maggiolo        | 97. Claudio Scialanca     |
| 5. Giuseppe Congera     | 99. Stefano Brandizzi     |
| 21. Giovanni Marziale   |                           |
| 36. Carlo Ziccardi      | Manager: Antonio Spignolo |
| 38. Giovanni Chigia     |                           |
| 52. Piero Bafaro        |                           |
| 54. Vittorio Loli       |                           |
| 55. Roberto Casablanca  |                           |
| 58. Paolo Tosetto       |                           |
| 60. Gianroberto Congera |                           |

## Malaysia O/60s



- |                              |                           |
|------------------------------|---------------------------|
| 1 M JOSEPH John Stephenson   |                           |
| 2 MUKHTIAR SINGH Avtar       | 17 DHALI WAL Surindar (C) |
| 4 ATTAR SINGH Manjinder      | 21 P VELAIUTHAM Chandra.  |
| 5 SUNDAR SINGH Harjit        | 23 SEQUERAH Collin        |
| 6 SINGH Sarjit               | 25 JESWANT SINGH Krishan  |
| 7 HOOI Ka Choy               |                           |
| 8 MAHAN SINGH Harmohan       | JAUHARI Zaiharin Manager  |
| 9 TARA Inderjit              | SINGH Sarjit Coach        |
| 10 CHIN Sow Ten              | ZAABA Mond Physio         |
| 11 MINDER SINGH Surjan       |                           |
| 12 BIN ABDUL AZIZ Mohd Nasir |                           |
| 13 MARKS TIO Raymond         |                           |
| 15 SHAH Azman                |                           |
| 16 BIN ABDULLAH Shamsul      |                           |

## Malaysia O/60s



- |                              |                      |
|------------------------------|----------------------|
| 1 BIN YAHAYA Azmi (GK)       | 15 SARJIT Awtar      |
| 2 BIN ABDULLAH Faizal        | 16 KOAY Teng Hin     |
| 3 ONG Seng Leong             | 17 DAVID Raymond     |
| 4 BIN MOHAMMED ASHRAF Kassim |                      |
| 5 KANMANI Tharmalingam       | 18 SEE Zoo Thai      |
| 6 ARULANTHU Anthony Samy     |                      |
| 7 SUNDAR SINGH Hari Singh    | BALASINGNAM K "Bala" |
| 8 AMAR SINGH Mohindar Singh  | - Team Manager       |
| 9 BIN ABDULLAH Abd Razak     | MURPHY James         |
| 10 THIND Hussanpal Singh     | - Head Coach         |
| 11 BIN HUSSIN Mohd Noor      |                      |
| 12 BIN TAWANG Ahmad Saufy    |                      |
| 13 MURUGESAN Mahendran       |                      |
| 14 FRANCIS XAVIER Gerard     |                      |





# Teams – Scotland, Singapore, Wales

## Scotland O/60s



- |                          |                           |
|--------------------------|---------------------------|
| 1. Scott Chisholm        | 49. Mike Gilbert          |
| 2. Ronnie Stott          | 50. Neil Sharp            |
| 7. Billy Taylor          | 51. Gurdial Duhre         |
| 10. Niall Sturrock       | 52. Alan Kerr             |
| 13. Benny Gibson         | 53. Arthur Robertson      |
| 17. Derek Johnstone      | 54. Derek Bell            |
| 41. Dave Sutherland      |                           |
| 43. Brian Edwards        | Coach: Neil Taylor        |
| 44. Timothy Walker       | Manager: Anne H-Chisholm  |
| 45. Stephen Springthorpe | Physio: Lucy Thompson     |
| 48. Mike Yellowlees      | Doctor: Rachel Sutherland |

## Singapore O/60s



- |                          |                           |
|--------------------------|---------------------------|
| 1. Mural Nair Chandra    | 12. Meng Chew             |
| 2. Uttam Baksheesh Singh | 13. Adam Lee              |
| 3. Ilango Somasundaram   | 14. Kumar Sundry          |
| 4. Parminder Singh       | 15. Suki Sandhu           |
| 5. Hans Sluijser         | 16. Sardol Baghail        |
| 6. Raj Patel             | 17. Satnam Suba Singh     |
| 7. Ali Abdul Rahman      | 18. Hernaikh Singh        |
| 8. Shekar Velu           |                           |
| 9. Kiran C R Sharma      |                           |
| 10. Johnson Vedhamuthu   | Coach: Nordin Manaff      |
| 11. Idris Mohamad Nasir  | Manager: Arul Subramanian |

## Wales O/60s



- |                     |                         |
|---------------------|-------------------------|
| 2 CHAPMAN Richard   | 23 WYATT Antony         |
| 4 HARBOTTLE Richard | 24 HARRIS Roger         |
| 6 HAVLIN Peter      | 25 ROBINSON Jeff        |
| 7 JOHNSON Ian       | 28 PADMORE Malcolm      |
| 8 SUMAL Inderpal    | 30 WILLIAMS John Peter  |
| 9 WRIGHT Derek      | 31 TIPPER Dave (GK)     |
| 10 LOTA Nari        |                         |
| 12 MONTGOMERY Nigel |                         |
| 14 RICHARDS Dave    |                         |
| 15 SMITH John       | MITCHELL Andy Coach     |
| 21 WHEATER Philip   | PADMORE Karen Manager   |
| 22 WITHERS Phil     | CHAPMAN Richard Manager |





# Teams – South Africa

## South Africa O/60s



8 PELL Steve	113 DAUVILLIER Ronnie	
101 METHVEN Gary	114 FISHER-HILL Alexander	
102 SHANKLAND James	116 FROELING Fred	
103 TURNER Glenn	117 JONES Gavin	
104 SOUTHERN Mark	118 HOLT Matt	
105 ETHERINGTON Richard		
108 EICHSTADT Carl		
109 BAKER Andrew (C)	GARRETT Steve	Coach
110 MUIR David	BROUGHTON Mike	Manager
111 COLLINS Mark	BAKER Liesl	Doctor
112 THOM James	BESTER Noelle	Physio

## South Africa O/65s



5 DRAKE Geoff	75 CAVANAGH Kelvin
6 NICOL Kevin (C)	83 WANCKEL Sean
13 KNIGHT Trevor	84 AZEVEDO José
19 COOK Mick	125 SCHOLTZ Pieter
29 PEEL Keith	
39 MASTERS John	
42 MARTIN Peter	
70 BEDFORD Glyn	HEWITT Warren Coach
71 KELLY Stephen	GILL Russel Manager
72 SHARDLOW Peter	BESTER Noelle Physio
73 DOTT Graeme	

## South Africa O/70s



3 BENSUSAN Dave	55 DUNNE Terry
12 RICHARDS Ross	56 SPOONER Ian
16 SURTEES Clive	59 ROBERTSON Kevin
21 FREEMAN Bobby	90 DAUNCEY Keith (C)
25 FRONEMAN Barry	93 COXELL Barry
31 FISHER Edmund	
32 SOLAN Rob	
34 DONALD John	HARTY Mary Manager
48 PALMER Rodney	SPOONER Ian Coach
50 RICHTER Ian (GK)	BAKER Liesl Doctor
52 MAYES Roger	BESTER Noelle Physio





# Teams – USA

# SoM - Alliance

## USA O/60s



- |                     |                           |
|---------------------|---------------------------|
| 1. Manzar Iqbal     | 13. Gurpreet Gill         |
| 2. Peter Jones      | 14. Joost Douwes          |
| 3. Alexander Rooks  | 15. Jaswinder Singh       |
| 4. Chowdhry Abid    | 22. Sankar Ramani         |
| 5. Brijinder Khosla | 24. William Larkins       |
| 6. Peter Bale       | 31. Jonathan O'Haire      |
| 7. Chamkaur Gill    | 32. Larry Zappone         |
| 8. Kewal Singh      |                           |
| 9. Mahesh Saraswat  | Coch: Nigel Traverso      |
| 10. Ian Tapsall     | Manager: Stanley Iyadurai |
| 11. Arvinder Virdee | Physio: Aaron Finer       |

## USA O/65s



- |                      |                     |
|----------------------|---------------------|
| 1 GRANAT rene (GK)   | 22 PREETINDER Brar  |
| 8 STARFIELD Jeffrey  | 25 SIDHU Kulwant    |
| 9 EICHERT Lance      | 26 SAHOTA Davinder  |
| 10 BHOWRA Onkar      | 27 MANGAT Raghbir   |
| 11 SINGH Paramjit    |                     |
| 12 SERRETTE Alva (C) |                     |
| 13 HUNDAL Waljeet    |                     |
| 14 DHUGGA Kashmir    |                     |
| 15 MICHAEL Darryl    | AKHTAR Amir Manager |
| 19 KOCH Todd         | SERRETTE Alva Coach |
| 20 RAZ Kavi          |                     |
| 21 SANDHAR Bhajan    |                     |

## Alliance O/70s



- |                       |                        |
|-----------------------|------------------------|
| 11 NAKAMURA Kiyotaka  | 207 WOOD Graham        |
| 47 KJEKSTAD Eric      | 213 BARTON Michael     |
| 52 BUTTON Mike        | 214 JOHNSON Anthony    |
| 79 UMEZAWA Yoshimitsu | 220 PATON Glenn        |
| 90 FARGUS David       |                        |
| 105 BROWN Nevelle     | BUTTON Penny Manager   |
| 136 TRESISE Rod       | Wood Walaiporn Manager |
| 146 WALKER Norman     | WOOD Graham Coach      |
| 159 LEARY Alan        |                        |
| 170 SONENBERG David   |                        |
| 171 WINNALL Steve     |                        |
| 193 DIENER Fredy      |                        |





# Spirit of Masters Teams – Southern Cross (Australia/New Zealand)

## Southern Cross O/60s



- |                    |                                |
|--------------------|--------------------------------|
| 2. Mark Studd      | 13. Darren McGiffen            |
| 3. John Davis      | 14. Trevor Nicol               |
| 4. Ian Harcla      | 15. Tony Virtue                |
| 5. Paul Marquardt  | 16. George Goodell             |
| 6. John Rogers     | 17. Ronald Lane                |
| 7. Mark Hulme      | 18. Brett Picknell             |
| 8. David Allen     |                                |
| 9. Daniel Forman   | Coach: Robert Malcolm          |
| 10. Michael Butler | Manager: Stephen Blakeley      |
| 11. Mark Lester    | Assistant Mng: Alistair McNab  |
| 12. Robert Malcolm | Assistant Mng: Christine Hayes |
|                    | Physio: Ross Swadling          |
|                    | Physio: Innalla Press          |

## Southern Cross O/65s



- |                      |                                 |
|----------------------|---------------------------------|
| 1. Bruce Cock        | 14. Ian Miller                  |
| 2. Mark Elliott      | 15. George Naylor               |
| 3. Wayne Harris      | 16. Noel Mitchell               |
| 4. Thomas Karp       | 17. Eric Staak                  |
| 5. Garry Royle       | 22. David Hart                  |
| 6. John Lensink      | 26. Andrew Terrey               |
| 7. Peter Hayes       |                                 |
| 9. Dannie Camilleri  | Coach: Peter Hayes              |
| 10. Gregory Willcock | Manager: Christine Hayes        |
| 11. David Gorman     | Assistant Mng: Alistair McNab   |
| 12. Stanley Hart     | Assistant Mng: Stephen Blakeley |
|                      | Physio: Ross Swadling           |
|                      | Physio: Innalla Press           |

## Southern Cross O/70s



- |                    |                                |
|--------------------|--------------------------------|
| 1. Marvin Heaston  | 12. Peter Scharnberg           |
| 2. Neil Waywood    | 15. Gil Straayer               |
| 3. Stephen Had     | 16. Bruce Winders              |
| 4. Thomas Long     | 17. Scott Blackwell            |
| 5. Keith Platel    | 24. John Ostaszewskyj          |
| 6. Kevin Keep      | 25. Ian Evans                  |
| 7. Michael Jenkins |                                |
| 8. Ross Gordon     | Coach: Ian Evans               |
| 9. Robert Ray      | Manager: Marlene Matthews      |
| 10. David Kennaway | Assistant Mng: Alistair McNab  |
| 11. Allan Harris   | Assistant Mng: Christine Hayes |
|                    | Physio: Ross Swadling          |
|                    | Physio: Innalla Press          |





# OFFICIALS & UMPIRES

## Umpires and Technical Officials

The Technical Director and Umpire Manager will be each be supported by several assistants, and we will have over 50 umpires and officials working at the event, from across the world.

### Technical Director

The TD for Tokyo is: Mr Kiyoshi SANA (JPN)

### Umpires Manager

The assigned UM is: Mr John HERON (SCO)

HARRISON Fiona (ATD) RSA  
HIRAO Yutaka (ATD) JPN  
MAVRIDIS Anthony (ATD) GRE

MASON Terry (AUM) AUS  
WATERMAN Alan (AUM) CAN  
KATO Naomi (AUM) JPN

### Technical Officials

HINCHLIFFE Jill AUS  
MACMILLAN Sue AUS  
SMITH Ian AUS  
WHITCHURCH Maree AUS  
KREUGER Markus GER  
ACRI Pietro ITA  
HALEY Merrill RSA  
BAYNE Lesley WAL  
HIRASAWA Miyuki JPN  
IMAJO Michiyo JPN  
KARIYA Kazuyo JPN  
MORI Yoshihiko JPN  
SEKINE Yumi JPN

### Umpires

ANDERSON Michael AUS  
CUTRALE Sam AUS  
HOCKEY Bruce (SX) AUS  
HURST Rod (SX) AUS  
MCMURRAY-W. Jockey AUS  
MILLAR Craig AUS  
ROSS David AUS  
WILLIAMS Neal AUS  
RANDHAWA Jasbir CAN  
MORALES Tony ESP  
BRADLEY Robert ENG  
CARTER Dan ENG  
SIHOTA Pritpal ENG  
LOGAN Mervyn IRL  
PINGITORE Salvatore ITA  
TOLOMEI Antonio ITA  
WELLS Andrew NZL  
BELCHER Clive (RSA) RSA  
CHILDS Paula (USA) USA  
SENNO Masato JPN  
KODAMA Shigeki JPN  
YUZAWA Nozomi JPN





# VENUE INFORMATION – 1 (OHS – Overview from West)

## Oi Hockey Stadium

The hockey competition will be held at Oi Hockey Stadium in Oi Central Seaside Park next to Tokyo Bay. This was the venue for the Olympic hockey in 2021 at the historic, postponed Tokyo Olympics. The nearest train station is OiKeibajo-Mae on the Tokyo Monorail and is about 10-15 minute walk **from** OHS.



At Oi Hockey Stadium there are two Olympic-standard water-based pitches with the stand of the Main Pitch holding 2600 spectators, and the Sub Pitch stand holding 500 spectators. The two pitches are within the same park facility but separated by an area of baseball fields, requiring a walk of about five minutes or more from pitch to pitch. On some days members of the public will be using the other sporting facilities located within the park (baseball, tennis, dog-run), so we will often be sharing some of the pathways outside the pitch areas with local people.





## VENUE INFORMATION – 2 (OHS Venue Map – Eastern View )

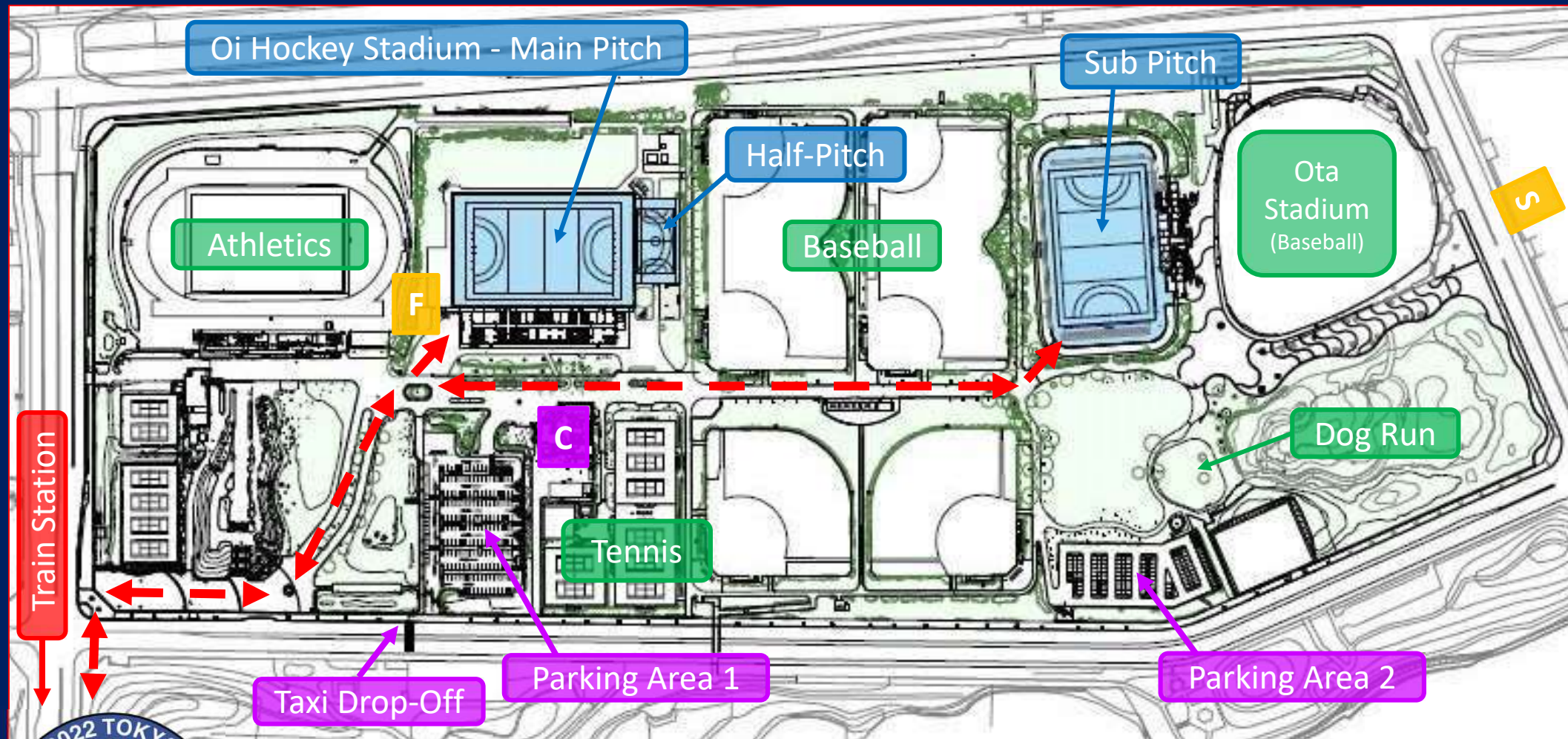

Red line indicates walking route from Station. 'F' = Food Trucks  
'C' indicates Park Centre Office. 'S' indicates Convenience Store



## VENUE INFORMATION – 3 (OHS Main Pitch Rooms)



## Undercover Area for Equipment Check

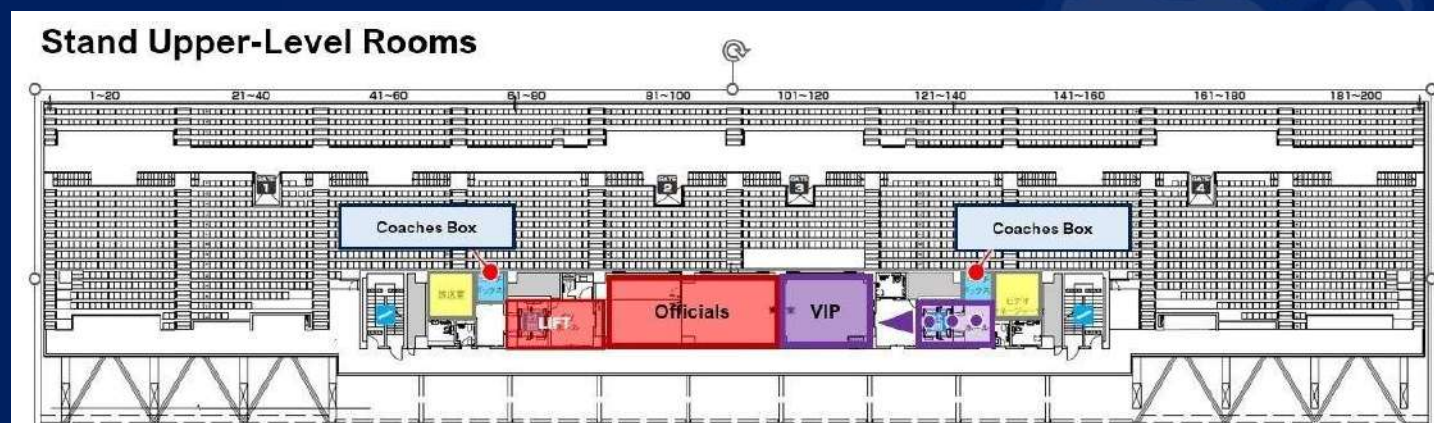
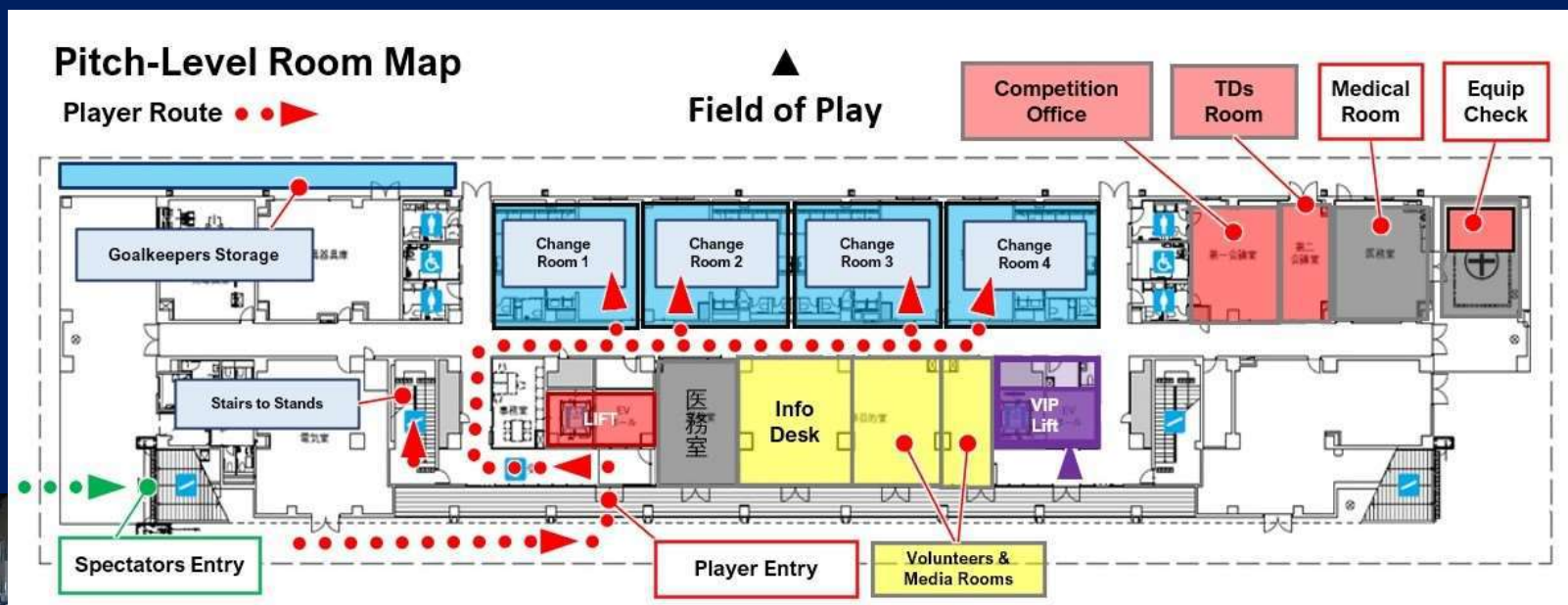



# VENUE INFORMATION – 4 (OHS Sub Pitch Rooms)

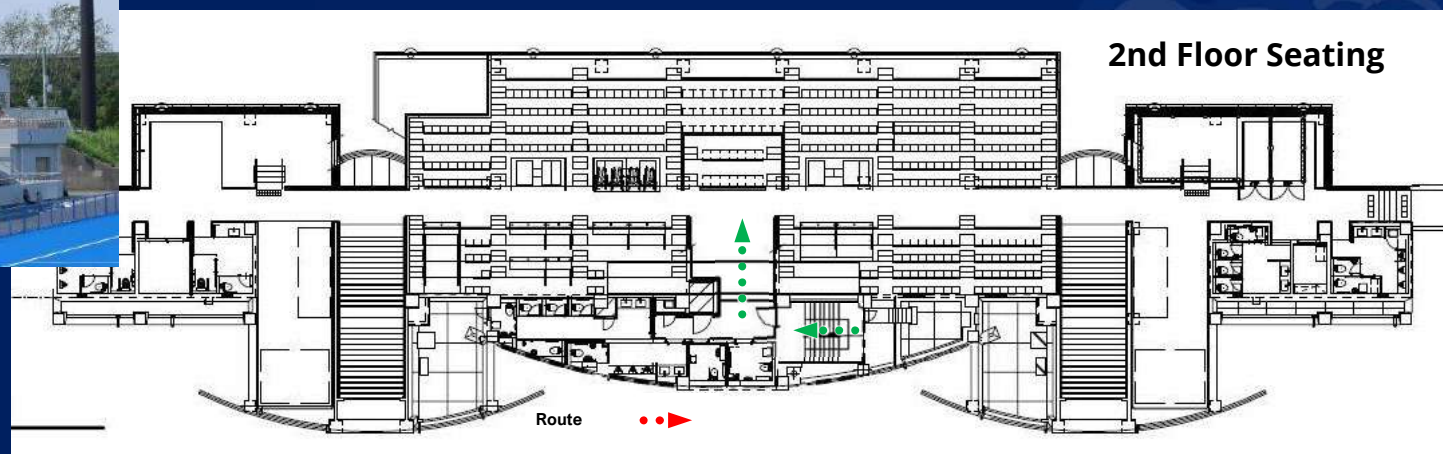
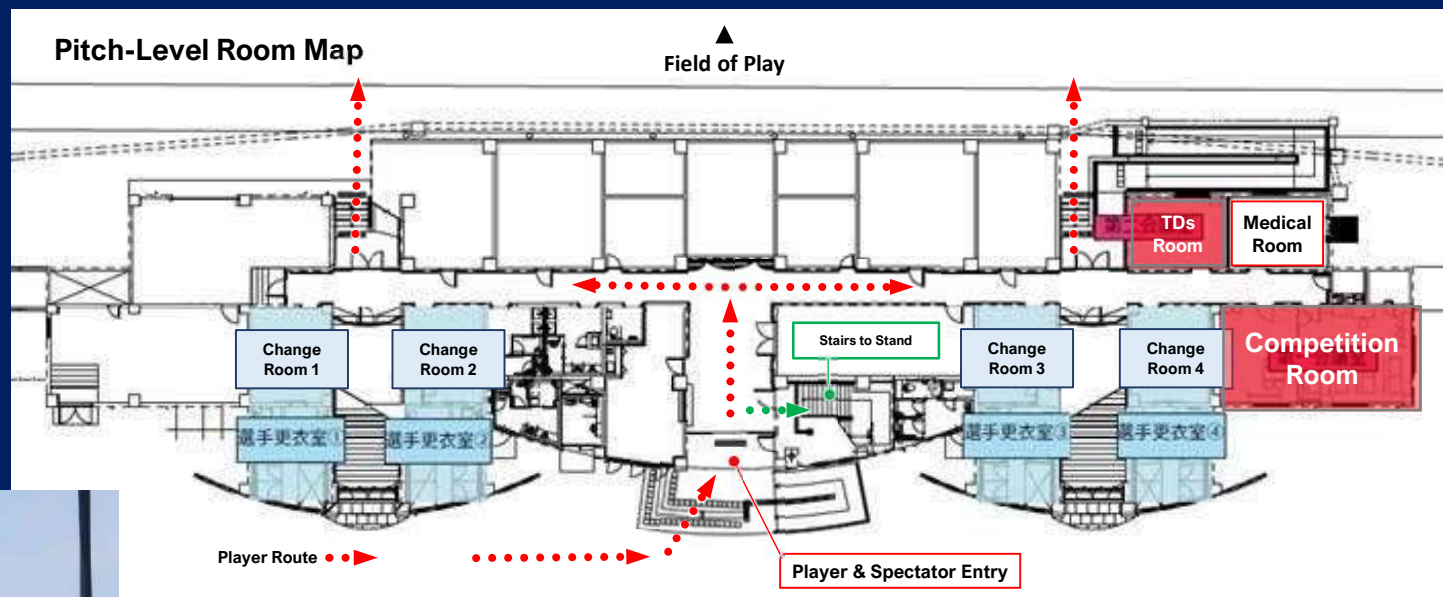

# TEAM INFORMATION - 2

## Changing Rooms

We have eight (8) dedicated changing rooms for the tournament. A schedule has been prepared to allow every team to have 40 mins before the game (until 30 mins before centre pass) and 40 mins after the game (from 15 mins after end of game). Your individual team schedule will be shared with you in October. We ask that you respect other teams and try to keep to the times allocated and to leave the changing rooms in a condition that you would wish to find them. All changing rooms have showers, toilets, a whiteboards, and an ice machine. The main pitch has a physio bench in each room.

## Goalkeepers Equipment Room

During the tournament, goalkeepers will be able to leave their equipment in a storage space under the Main Pitch stand. For security this area will be monitored by volunteer staff. Teams will be allocated their own space in the area, and we ask that teams be considerate when sharing this area and leave it as tidy as possible. Teams can also leave other heavy/large equipment such as practice balls and/or storage boxes in the space.

## Video Recording of Matches

There will be designated locations at each pitch from which teams can video. However permission must first be granted for this. Please contact Tokyo HNOC. Mounting a GoPro on the fence behind the goal will probably be allowed.

## Rubbish

There are few rubbish bins at the venue so we ask that everyone takes their rubbish with them where possible, please.





# TEAM INFORMATION - 3

## Team Liaison

Prior to the start of the tournament the main contact for team liaison is Kevin DEMPSTER who can be reached on [kevin.d@iinet.net.au](mailto:kevin.d@iinet.net.au) At the start of the tournament each team will be allocated a Team Liaison Officer (TLO) who will be available to support you with any issues you may be facing. Your TLO will be in touch with you when you arrive in Tokyo.

## Information Desk

There will be several tournament Information Desks – one underneath the Main Pitch stand, and at some team hotels.

## Lost & Found

Please ask at the Information Desks

## Catering at Oi Hockey Stadium

Food vans/trucks will be stationed at the stadium each day of the tournament, offering various types of food, Drinks vending machines are also available in various locations around the venue.



# DIGITAL INFORMATION

**Wi-Fi** Tokyo City has free Wi-Fi points available around the venue, but these have limited strength.

Connect to FREE\_Wi-Fi\_and\_TOKYO

## Event Website

Our website is updated on a regular basis with information on the tournament and also new offers and ideas for how to make the most of your time in Tokyo. Please check in regularly to see developments before the tournament. You can also access additional services and activities that need pre-booking. <https://mhwc2022tokyo.com/>

## Social Media

The Tokyo event will be posting on the WMH Facebook site as well as Twitter and Instagram. Please let us know when you have an update on your team. We would love to hear how your preparations and tournament are going.

## Live Streaming

The final five days of the tournament will be live-streamed at the following YouTube link:

[https://www.youtube.com/playlist?list=PLkI5D8cMpIFCU2TQ-hPell\\_9kw5cPR7zL](https://www.youtube.com/playlist?list=PLkI5D8cMpIFCU2TQ-hPell_9kw5cPR7zL)





# EMERGENCIES & MEDICAL TREATMENT - 1

## Health & Safety - Emergency Information

The Event Management Plan contains procedures for a range of potential incidents. Full details can be found on the Event website at the following link: <https://OOOOOOOOOOOOO> (TBC) . The procedures cover the following areas: Suspicious packages, Lost children or vulnerable adults, Major incident and evacuation plans.

In case of a major incident the Emergency Rendezvous Points are on the actual Hockey Pitches themselves. The areas will be signposted. In case of emergency, Event Management will use the venue speakers to direct people to the appropriate place.

Other urgent situations can be reported at any time to the Information Desk on the pitch-level floor of the Main Pitch stand, or to the Competition Office.

## Medical Facilities

Medical services will be provided in the medical room, near changing rooms at both pitches as well as a response team on the FOPs when required. These teams will be backed up by services at one designated hospital. Medical services will be managed by a head doctor, and trained nurses, positioned at each pitch during competition. Please note: Medical expenses are your responsibility. Please prepare your own protective measures, such as taking out overseas travel accident insurance.

## Case 1

Injuries and changes in physical condition during a game

- First Aid : Team Doctor and Physio support
- Host Country Organizing Committee Medical Support

Contact : Dr. Takeo ARAI

Mail Address : [mhwc2020tyo\\_med\\_arai@a05.itscom.net](mailto:mhwc2020tyo_med_arai@a05.itscom.net)

Mobile Phone : 090-5783-9178

If hospitalization, examination, or (orthopaedic) surgical treatment is necessary, the HNOC doctor will request transport to an emergency hospital.



# MEDICAL TREATMENT & COVID MEASURES - 2

## Case 2

Fever/feeling unwell at the hotel and/or during daily activities

- ① Temperature check by individual
- ② Team Doctor examination/diagnosis  
(or hotel/family doctor/examination)

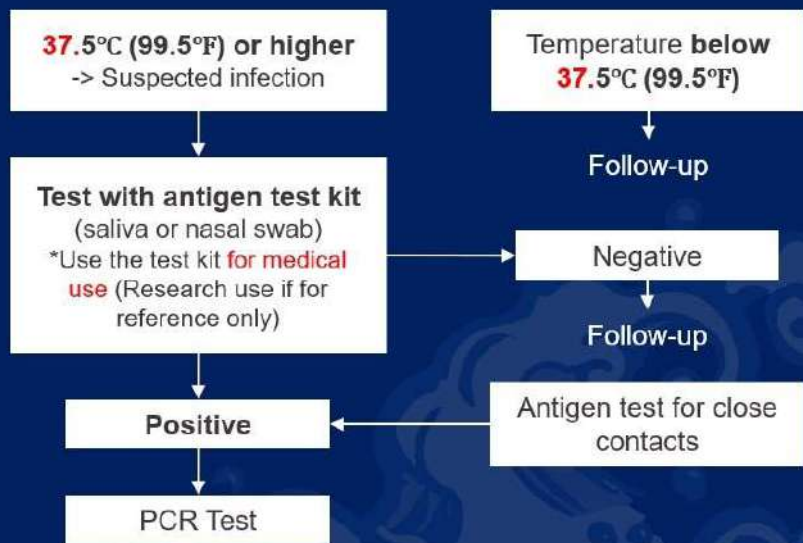

Follow Tokyo's latest infected person regulations link;  
<https://www.fukushihoken.metro.tokyo.lg.jp/english/visitors.html>

## Case 2 (continued)

HNO Medical Organization Medical test kit prep instructions

- The team representative will provide the name and symptoms of the infected person and report to Dr. ARAI.
- In the event of a sudden change in condition while recuperating at the hotel, the patient will be transported to the hospital.

## Case 3

If you need to be hospitalized during the tournament

**Tokyo Shinagawa Hospital** is recommended as a destination for hospitalization and outpatient treatment other than corona infection

Phone : 03-3764-0511

Address : 140-8522 Shinagawa-ku Higashioi 6-3-22

## Postscript

Each team should prepare a considerable number of thermometers (electronic thermometer) and COVID19 (Corona) antigen test kits. HNO will also prepare thermometers, & antigen test kits.





# COVID MEASURES (Precautions)

## Protective Measures against COVID19 Infection at WMH World Cup 2022 Tokyo

### 1. Reminder to the Participants

- \* All participants should monitor their own health carefully by checking their temperature daily and reporting any signs of sickness.
- \* Teams should carry Rapid Antigen Testing kits for checking any members will COVID symptoms.
- \* Team members including Players, Team Managers, Coaches, and other Team Officials should refrain from participating in that day's competition when they detect any health problems.

### 2. COVID Infected Participants must:

- \* Immediately report their condition to the HNOC if they test positive for COVID.
- \* Positive cases must follow the regulations set out by the City of Tokyo for infected persons.
- \* The HNOC will meet and decide about the patient's further participation in the Tournament.

### 3. Precautions Outside the Hockey Stadium

- \* It is strongly requested that participants wear a mask when they are using public transport and taxis.
- \* Please also wear a mask in hotel lobbies, restaurants, & shops.

### 4. Precautions Inside the Hockey Stadium

- \* There will be a temperature check and hand-sanitation station at the stadium entry.
- \* If a fever higher than 37.5C is detected, the person will be asked to not enter the stadium.
- \* Team Meetings should be held outdoors as much as possible.
- \* Please wear a mask when moving between the two pitches.

### 5. Precautions During a Match

- \* Teams should avoid sharing equipment, and should disinfect equipment where sharing is unavoidable.
- \* Protective Face Masks for PCs must be have identification for use by individual players.
- \* Team Bench officials should sit apart where possible and wear a mask. They should refrain from shouting.
- \* Each team must clean and disinfect the bench after their match.
- \* Each team must clean their changing room before they leave.



# TRANSPORT - 1

## Getting to the Venue

The venue is easily accessible by public transport, especially with Tokyo's extensive system of trains and subways. Taxis are also readily available.

## Train Access

The nearest train station is OiKeibajo-Mae on the Tokyo Monorail and is about 10–15 minute walk from the hockey stadium. The next nearest station is Tachiaigawa Station on the JR Keikyu line which takes a 25-30 min walk.

## Train Pass Cards

The easiest way of getting around on the trains and subways is with a pass card which you just tag on and off at the station entry gate. The 'Suica' card and 'Passmo' cards are the most popular, and can be purchased (and recharged) at ticket machines near the entry gate. A new card costs ¥500, and can also be used like cash card at kiosks and vending machines.





# TRANSPORT - 2

## Local Taxi Companies

Local taxi companies: (or easily hailed from roadside)

Nihon Kotsu 03-5755-2336 (English OK)

Taxi Checker 03-3573-3751 (Japanese)

Tokyo Musen 03-3361-2111 (Japanese)

Musen Haisha Centre 03-3406-7171 (Japanese)

## Venue Address

Oi Hockey Stadium 大井ふ頭中央海浜公園ホッケー競技場

Oi Futochuo Keihin Koen (Oi Park) 大井ふ頭中央海浜公園

4-1-9 Yashio, Shinagawa-ku, Tokyo 品川区八潮4丁目 1-19

Postcode 140-0003

## Parking at OHS

Limited parking facilities are available at the hockey stadium sports park. Please see the map on Slide 13 for the two locations. The cost is ¥200-300 (TBC) per hour.



# SOCIAL & ADDITIONAL ACTIVITIES - 1

## Tournament Dinner

We are delighted that Japan Masters Hockey will be hosting the Tournament Dinner on Friday 28th October. You will be receiving a separate invite to this event. Please ensure that each of your Team Managers have received this information. The event will start at 5:30pm and will be held at Meiji Kinenkan Garden in central Tokyo.

## Opening & Closing Ceremonies

The tournament will be formally opened on Tuesday 18th October. The ceremony will take place on the Main Pitch at 3pm at OHS. All national and team squads are expected to be represented to formally open the tournament.

Following completion of the last final, the tournament will be formally closed in a ceremony hosted by World Masters Hockey and Japan Masters Hockey. This will take place on Saturday 29th October on the Main Pitch at OHC from 4:00pm





# TRAVEL & SIGHTSEEING - 1

## Tokyo Airports

For international travellers flying into Japan, Tokyo has two international airports – Narita & Haneda. Both of these airports are well serviced by transport facilities into downtown Tokyo.

Distance and time from airport by train to central Tokyo:

Narita Airport – 70km in 60 mins (Direct train)

Haneda Airport – 20km in 30 mins (One train change)

Narita is larger with more facilities and more international airlines. Limousine express buses are also available from each airport, and take about the same time.

Further information can be found on the airport websites:

Narita : <https://www.narita-airport.jp/en/access>

Haneda : <https://tokyo-haneda.com/en/access/index.html>

## Japan Rail Pass

If you plan to travel around Japan during your visit for the World Cup, the best way to get around is by the super-express 'Bullet Train'. So it is highly recommended that you purchase a 'Japan Rail Pass', because it can save you a lot of money. The Rail Pass is available for one-week, two-week, or three-week periods. The cost of a one-week pass is about the same as a round-trip ticket from Tokyo to Kyoto, but you would then have the cost-free option of travelling ANYWHERE else in Japan, and on many local lines and buses too – not only bullet trains. A voucher for a Rail Pass needs to be purchased from a travel agent in your home country before coming to Japan. More information can be found at : <https://japanrailpass.net/en/>





# TRAVEL & SIGHTSEEING - 2

## Tokyo City

..is the largest metropolis in the world, with its unique contrasts in ancient and modern architecture – including temples & gardens, and the Emperor's Palace. Climb Tokyo Skytree or cross Rainbow Bridge on a driverless train. Then Tokyo really comes alive at night with it's spectacular neon streets. Exploring is easy with Tokyo's extensive system of trains and subways.





# TRAVEL & SIGHTSEEING - 3

## Tokyo's Surrounding Areas

There are some great day-trips outside of Tokyo. Head to Tokyo Disneyland in nearby Chiba prefecture, or see the giant Gundam robot in action in neighbouring Yokohama City. Visit the Cup Noodles Museum there too. Further away you might get a glimpse of Fuji-san in Hakone. Then there is the majestic big Buddha in Kamakura. To the north there is Nikko with it's incredible decorative temples and gorgeous waterfall. Enjoy!





# TRAVEL & SIGHTSEEING - 4

## Shinagawa City – Home of the Olympic Hockey Stadium

OHS is located within the Tokyo city ward called Shinagawa. As an important stopover from Tokyo on one of Japan's main travel routes, the Shinagawa area was historically a busy hub for travellers and merchants. Nearby Tokyo Bay also provided water traffic and seafood resources. Even today there are still remnants of this history, including famous temples and shrines, and a few old shops and inns.

Local tourist services can offer a number of cultural 'experiences' including bay-cruising on a traditional 'dinner-boat', a Buddhist zazen session, tea ceremony, lacquer-ware or traditional sweets-making. There will be a information booth from Shinagawa City at OHS to assist you with sightseeing ideas and booking tours. Click here!

<https://shukuba.jp/hockey/>





# TRAVEL & SIGHTSEEING - 5

## Shinagawa - Home of Hockey.... And Horse Racing!

The area near the hockey stadium is also very famous among Tokyo people for it's horse racing venue - Oi Keibajo. There aren't any actual races while the World Cup is on, but you can still enjoy the well-known colourful night-time illuminations at the track (Sat Oct 22nd & Sun 23rd Oct)



All World Cup participants will be receiving a Free Ticket at the Hockey Stadium on October 18th for the illumination show!



# GENERAL INFORMATION - 1

## Weather & Temperatures in October

Autumn is the best time of year to visit Japan, with comfortable temperatures 25-15°C. You will need a light jacket and a warm undershirt for the cooler days. Predictions are that this October may be a little wetter than usual so bring a fold-up umbrella just in case. Also bring a hat, sunscreen, and sunglasses for the sunnier days.

## Electricity and Sockets

The voltage in Japan is 100V while the frequency is 50Hz/60Hz in Japan and 50Hz in Tokyo. The sockets, as illustrated, will be used in all buildings and are compatible with A type plugs (the type with a two flat pins). Multiregion adaptors will be available to purchase at nearby convenience stores. Foreign appliances will most likely require adapters and/or transformers.

## Tap water

Tokyo's tap water is completely safe to drink and conforms to strict quality regulations. Bottled water is also available at convenience stores and out of the seemingly endless number of vending machines.

## Language

Standard Japanese is the main language in Japan, but Tokyo is becoming a much more foreigner-friendly city. Especially in the major tourist areas, English can be generally understood.

Shinakamon – Seagull  
mascot for Shinagawa city





# GENERAL INFORMATION – 2

## Money

The yen (JPY, ¥) is the currency of Japan. Bills come in denominations of 10,000, 5,000, 2,000, and 1,000, although 2,000 bills are rare. Coins come in denominations of 500, 100, 50, 10, 5 and 1.

## Banks and ATMs

If you want to withdraw money from your own account in yen, many international banks have at least one Tokyo branch. Most major Japanese banks now accept international cards at their ATMs, as do the Japan Post Bank ATMs found in post offices. ATMs can also be found inside most convenience stores and shopping centres.

## Changing money

Money can be exchanged at currency exchange counters located mainly at banks, post offices, hotels and airports.

## Credit cards

Most major credit cards are accepted at major stores and facilities. When checking in to a hotel, they serve as identification in lieu of a cash deposit. Note, however, that there are still a few facilities that do not accept credit cards at all, and others may accept only certain types, so it is advised that you carry some cash at all times.

## Tipping

There is no tipping culture in Tokyo, so the final bill you receive at cafes, bars and restaurants is the final price that you need to pay. In some restaurants, a fixed percentage service charge is added to the bill.



# GENERAL INFORMATION – 3

## Free Wi-Fi Services

Free Wi-Fi is becoming increasingly available throughout the city. Many major hotels, coffee shops, restaurants and public facilities offer a free Wi-Fi service. However, for guaranteed internet access wherever you roam, pocket- Wi-Fi devices are available for rent from kiosks at the airport, or pick up a travel sim to fit into your existing phone.

### Tokyo Free Wi-Fi

Where: Around Tokyo

How: Select the 'FREE\_Wi-Fi\_and\_TOKYO' SSID, launch your web browser, tap "Access the Internet here" and follow the instructions on the screen.

Metro Free Wi-Fi + Toei Subway Free Wi-Fi

Where: 210 subway stations in Tokyo

How: Select the 'Metro\_Free\_Wi-Fi' or 'Toei\_Subway\_Free\_Wi-Fi' SSID, launch your web browser, and follow the instructions on the screen.

## Telephone Services

The country code for Japan is 81. When calling from outside of Japan, dial the international dialling access code, which differs by country, then dial 81.





# GENERAL INFORMATION – 4

## Noise

Tokyo and Oi Hockey Stadium can be a noisy place! The hockey stadium is in the direct approach line path for nearby Haneda Airport so there are times when there is continuous noise from multiple planes coming in to land - with some planes flying directly over the stadium. The large flock of squawking crows which live at the stadium don't seem to mind though.

## Typhoons

October is the end of the typhoon season, but if one hits Tokyo, it could bring destructive winds and flooding, causing competition to be disrupted for a day or so. Fortunately we have forecasting systems which can monitor such storms many days before they arrive. So please heed any warnings to stay indoors at such times.

## Earthquakes

Japan is a land of frequent earth tremors - most being very minor and almost undetectable. However if a very severe earthquake occurs, you must take precautions to protect your life. Indoors and outdoors watch out for falling objects and protect your head. Alarms will sound but avoid panicking, as this can cause injury. Fires could also be triggered so be ready to evacuate if instructed to do so. The evacuation area at OHS will be on the hockey pitches themselves. If you are travelling near the coastline, beware of tsunami warnings which may require you to evacuate to higher ground. Tokyo Bay near OHS is mostly a safe area from tsunamis.

## Emergency Phone Numbers

If you find yourself in need of assistance, dial the appropriate number : Police 110, Police (English) 03-3501-0110. Fire Emergency/ Ambulance 119

On many street corners, small police boxes - known locally as 'Koban', support the local area. Drop in for directions, lost and found, or any traffic related incidents.



# THANK YOU!

## Enjoy your hockey in Tokyo!



スポーツ振興基金  
独立行政法人日本スポーツ振興センター